

Package Contents

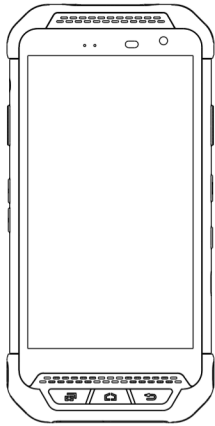

- PM85
- AC/DC Adapter (5V 2A)
- USB Type-C Cable
- AC Plug Heads
- Battery
- LCD Protection Film
- Quick Start Guide
- Hand Strap

Device Layout

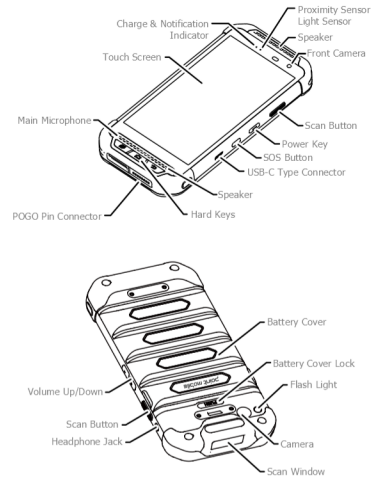

Hard Keys

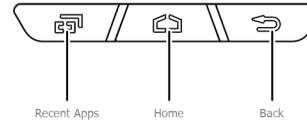

Recent Apps Key

- Press to see recently used apps.

Home Key

- From any apps or screens, press to return to the Home screen.

Back Key

- Press to go back to the previous screen, or to close a dialog box, options menu, notification panel, etc.

Removing Battery Cover

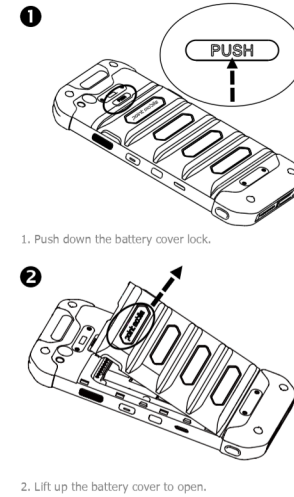

1. Push down the battery cover lock.

2. Lift up the battery cover to open.



STAY ON TRACK WITH THE ALL-PURPOSE MOBILE COMPUTER

Quick start guide

PM85

Inserting Battery

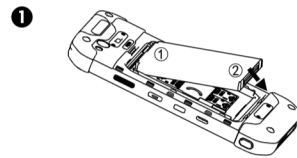

1. Insert battery from the top first, then put in the bottom.

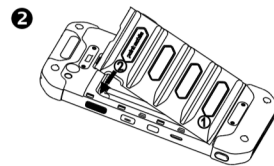

2. Insert the battery cover from the bottom first.

Installing SIM-SAM/Micro SD Card

Installing SIM-SAM card/Micro SD card

You must insert your SIM card to make phone calls. Please turn the device off before inserting or removing the SIM card.

1. Remove the Battery Cover and Battery.
2. Lift up the SIM rubber.
3. Insert the SIM-SAM/Micro SD card into the slot, with the gold plate facing down. Make sure that it is inserted correctly.
4. To remove the card, repeat step1 and step2, then remove the card out of the slot.

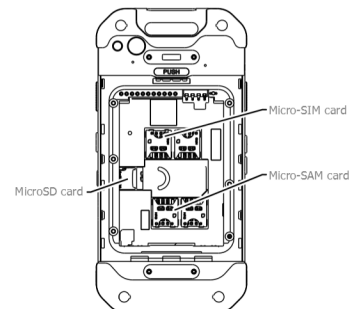

<Caution>

- Your device only supports Micro SIM and SAM cards. Do not attempt to insert other SIM or SAM types such as "Nano"; this may cause damage to your device. If you have to use different SIM card types, please use a "SIM adaptor".
- Device supports storage extension up to 32GB with micro SD card.

Charging the PM85

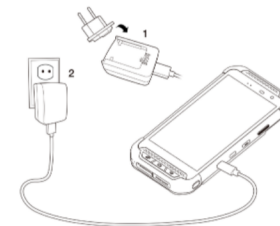

1. Insert USB connector into the adapter and connect to an electrical socket to charge.
2. LED indicator will display charging status.

LED State	Indication
Steady Red	Battery is charging or the battery level is low
Blinking Red	Battery level is critically low
Steady Green	Battery is fully charged

Standard Battery	2,900mAh 3.85V
Extended Battery	5,800mAh 3.85V
Charging Time	Standard Battery: About 4 hours
	Extended Battery: About 6 hours

<Caution>

1. Always use an original charger and cable from the Point Mobile. Other chargers and cables may damage the PM85. In addition, make sure connector, charger, cables are not wet.
2. You can also charge the device with optional accessories such as single or dual slot cradles.

- For more details of product information and user guide, please refer to our website (www.pointmobile.co.kr)

Accessories

Standard Accessories

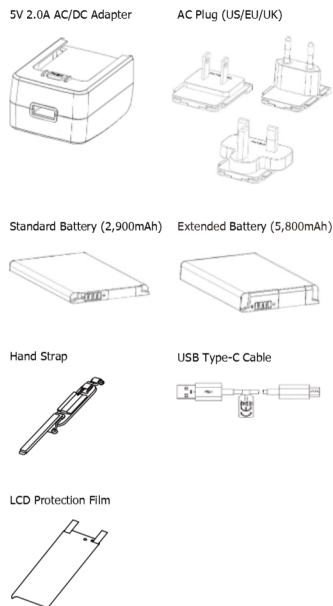

Reset the PM85

Force shutdown

Press and hold the Power button for at least 8 seconds to power off or hold it longer to restart.

Factory reset

Follow the process by tapping the next button to complete factory reset.

Settings -> System -> Reset options -> Erase all data (factory reset) -> RESET PHONE -> ERASE EVERYTHING

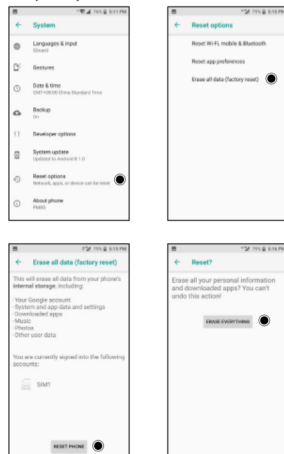

<Caution>

Please note, all apps and data in the internal storage will be deleted and restored to factory settings and this process cannot be undone.

Accessories

Optional Accessories

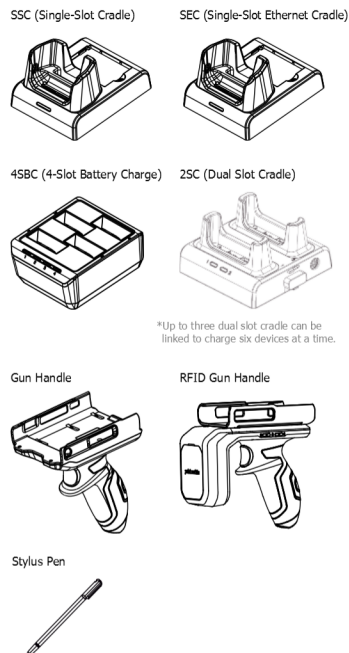

*Up to three dual slot cradle can be linked to charge six devices at a time.

Support

ARS: +82-1800-3010
 Fax: +82-2-3397-7872
 Address: B-9F Kabul Great Valley, 32, Digital-ro 9-gil, Geumcheon-gu, Seoul, Korea 08512

Website: <http://www.pointmobile.co.kr/>
 E-mail: pm_support@pointmobile.co.kr

For more information

Please refer to the user manual for more information on safety & regulations of device and accessories.

Certification

Equipment name: Mobile computer
 Model: PM85
 Trade name of certified: Point Mobile Co., Ltd.
 Manufacturer: Point Mobile

For more certificate information, go to Settings -> System -> About phone -> Certificates

Getting Started

Turning the device on and off

- Press the Power button to turn on the device. After a few seconds, device will turn on.

- Press and hold the Power button for a few seconds and tap 'Power off' on the screen options.

Set up

Start with setting the input language, google account, GPS, etc., when the device is turned on for the first time.

Home screen items

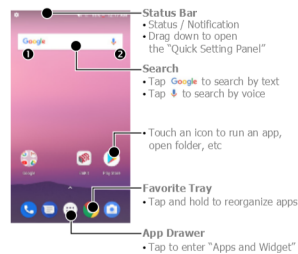

Google, Android, Google Play and other marks are trademarks of Google LLC.

Status & Notification Icons

Status icons

	EDGE connected		Strong signal
	GPRS connected		Good signal
	3G connected		Weak signal
	LTE connected		Connection issue
	No SIM card installed		No data connection
	Airplane mode		Hotspot enabled
	Data communication		
	Wi-Fi turned on		Connected to a Wi-Fi network
	Bluetooth turned on		Connected to a Bluetooth device
	Battery is full		Battery is partially drained
	Battery is low		Battery is very low
	Battery is charging		
	Location service turned on		Using location service
	Speakerphone turned on		Headset with MIC connected
	Vibrate mode		Phone mic is mute

Notification icons

	Missed call		New SMS or MMS message
	New Email		Connected to VPN network
	Upcoming event		Alarm is set
	App update available		Screenshot captured
	Preparing SD card		SD card removed, unexpectedly
	OTG device connected		
	File uploaded		File downloaded
	File copied		
	Scanner turned on		USB connect mode selection
	There are more notifications		Other input method available

Specifications

Item	Specifications
Model	PM85
Operating System	Android 8.0 or higher version (GMS certified)
Software	Tools and Demos
Micro-Processor	Qualcomm® Snapdragon, Octa-core, 1.8GHz
Memory(RAM/ROM)	3GB RAM+32GB Flash/4GB RAM+64GB Flash (Optional)
Memory Extension	User accessible Micro SD memory card slot.
Display	5.0" Wideviewing angle IPS (FHD 1080 X 1920 pixels)
Keypad	Touch screen & Front keypad
Audio	Built-in microphone and speaker
Weight	With standard batt. 256g / 9.03oz With extended batt. 315g / 11.11oz
Wi-Fi	802.11 a/b/g/n/ac/dh/wi/t/v
UMTS / HSPDA / HSUPA	EDGE/GPRS/GSM: 850/900/1800/1900 WCDMA: B1/2/4/5/6/8/19 LTE FDD: 1/2/3/4/5/7/8/12/13/14/17/19/20/28 LTE TDD: B38/B39/B40/41
Bluetooth	Bluetooth v5.0, class 1
GPS	Qualcomm GPS
NFC/RFID	13.56MHz
USB	USB type-C (Support USB 2.0 OTG)
Battery	Li-ion battery: 2,900mAh, 11.2Wh, 3.85V 5,800mAh, 22.4Wh, 3.85V
Adapter	Output: 5V / 2A, Input: 100-240V~50/60Hz 0.4A
Battery Capacity / Charging Time	Capacity: 2,900mAh - About 4 hours 5,800mAh - About 6 hours
Operating Temperature	-20°C ~ 60°C
Rain/Dust Protection	IP67

Safety information

Please note your phone is battery-embedded design with removable battery and battery cover. Unauthorized personnel are strictly prohibited from disassembling the phone. Make sure to use only the power adapter (5V 2A Output AC/DC) that came with PM85.

In case your phone does not work as expected, you are strongly recommended to restart it by pressing and holding the power button for at least 8 seconds until the startup screen appears. If your phone has encountered a serious error and cannot be recovered, you should reset your phone to factory settings by using the menu, either "Backup & Reset" or "Factory Reset".



www.sar-tick.com

Body-worn operation

This device was tested for typical body-worn operations with the front & back of the phone kept 0.2 inches (0.5 cm) between the user's body and the front & back of the phone. A minimum separation distance of 0.2 inches (0.5 cm) must be maintained between the user's body and the front & back of the phone. Any belt clips, holsters, and similar accessories containing metallic components may not be used. Body-worn accessories that cannot maintain 0.2 inches (0.5 cm) separation distance between the user's body and the front & back of the phone, and have not been tested for typical body-worn operations should be avoided.

Protect your hearing

To prevent possible hearing damage, do not listen at high volume levels for long periods. Exercise caution when holding your device near your ear while the loudspeaker is in use.

